

ADJUSTABLE PERFORMANCE FEATURES

1. Variable click sear

The Tru-Fire Sear's defining feature is it's ability to give the user a choice between 4 different clicks; short (I), medium (II), long (III), and no click

2. Hot/Cold mirco adjustment

Adjusts how quickly the user reaches the click

3. Interchangeable 3rd/4th finger

Easily converts from a 3-finger release to a 4-finger release

4. Sweeping 4th finger

Conforms to the users style and comfort by offering the ability to adjust the sweep angle of the 4th finger attachment up to 45 degrees

5. Multiple position thumb post

Allows the user to customize the thumb post position to one of three location for optimum comfort and feel

Magnet assist reset *

RELEASE PERFECTION

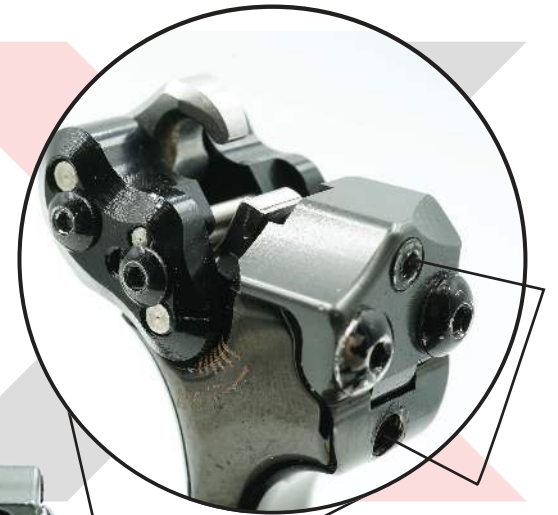

Variable click sear

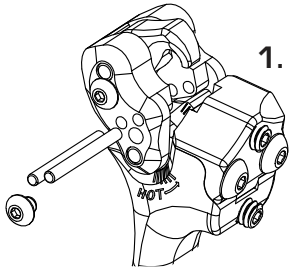

1. Using a .050" hex key, remove the button head screw that holds limiting pins in place. Remove the limiting pins.

2. Using a 1/16" hex, back out the lower hot/cold micro adjust set screw until threads are visible.

3. Using a 1/16" hex, remove the two screws securing the set block to the release head.

4. Rotate the four sided sear to the desired setting and reassemble.

*The sear can be adjusted and retain the same hot/cold setting by NOT adjusting the top hot/cold micro adjust screw.

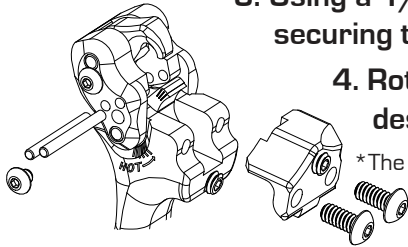

Note: Click setting is indicated by the marks on the sear (I, II, or III)
The active click is the numeral immediately counterclockwise of the numeral shown.
Example: If the numeral III is showing, II (medium click) is active.
See Hot/Cold Adjustment diagram to the right.

Hot/Cold Adjustment

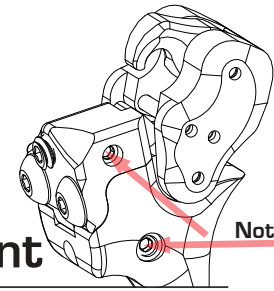

Note: Factory set.
Do not adjust.

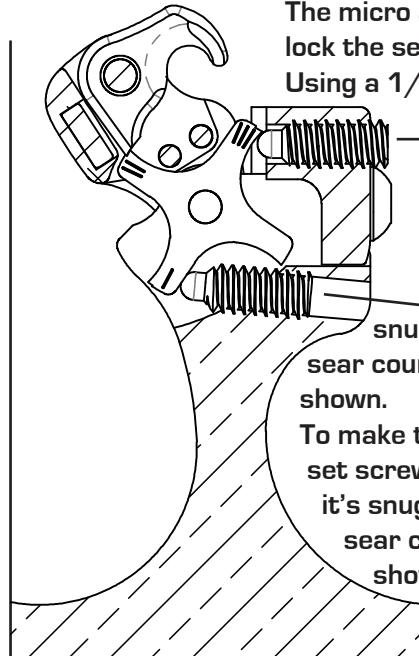

The micro adjust set screws engage and lock the sear in the desired position.

Using a 1/16" hex to adjust the set screws equal and opposite each other, loosening one before tightening the other.

To make the release hotter, loosen the bottom set screw, then tighten the top until it's

snug against the sear. This rotates the sear counter clockwise in the head orientation shown.

To make the release colder, loosen the top set screw, then tightening the bottom until it's snug against the sear. This rotates the sear clockwise in the head orientation shown.

Note: It's recommended that adjustment are done in small increments.

Interchangeable 3rd/4th finger

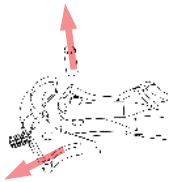

1. Using a 1/16" hex key, loosen the set screw and remove the pin as shown on left. Once the pin is removed, remove the 3-finger attachment.

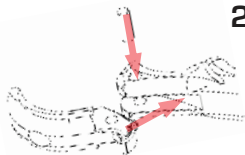

2. Insert the 4th finger attachment, and replace the pin as shown. Tighten down each set screw.

Sweeping 4th finger

1. Using a 1/16" hex key, loosen/tighten the two set screws to set the desired angle of the 4th finger attachment.

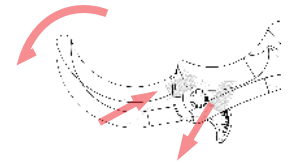

2. When the desired angle is reached, make sure each set screw is tight.

