





***MATCH THE HOLES ON THE
CROSSBOW TO ONE SET OF
THE HOLES DRILLED ON THE
BENT END OF THE BRACKET,
MAKE SURE THE THREADING
END OF FLOAT ADAPTOR
SHOULD BE FACING TO THE
FRONT OF THE BOW***

***NOW MOUNT THE REEL
MOUNTING PLATE ON
THE OPPOSITE SIDE
FROM THE BENT
SECTION WITH THE
SCREWS PROVIDED
WITH THE REEL.***





NOW ATTACH THE REEL TO THE BRACKET BY INSERTING THE WING NUT INTO THE BRACKET AND TIGHTEN FIRMLY.

WARNING: KEEP THUMB AND INDEX FINGERS BELOW THE PATH WHEN SHOOTING TO AVOID BODILY INJURY

WARNING: Shooting without proper crossbow and rail assembly. Consult operators manual. Backing loosening, primary. Completely remove. Backing.

**NOW SCREW THE FLOAT ADAPTER
INTO THE THREADED SQUARE SEC-
TION ENSURE THIS POINTS IN THE
DIRECTION THE ARROW WILL BE
TRAVELING**

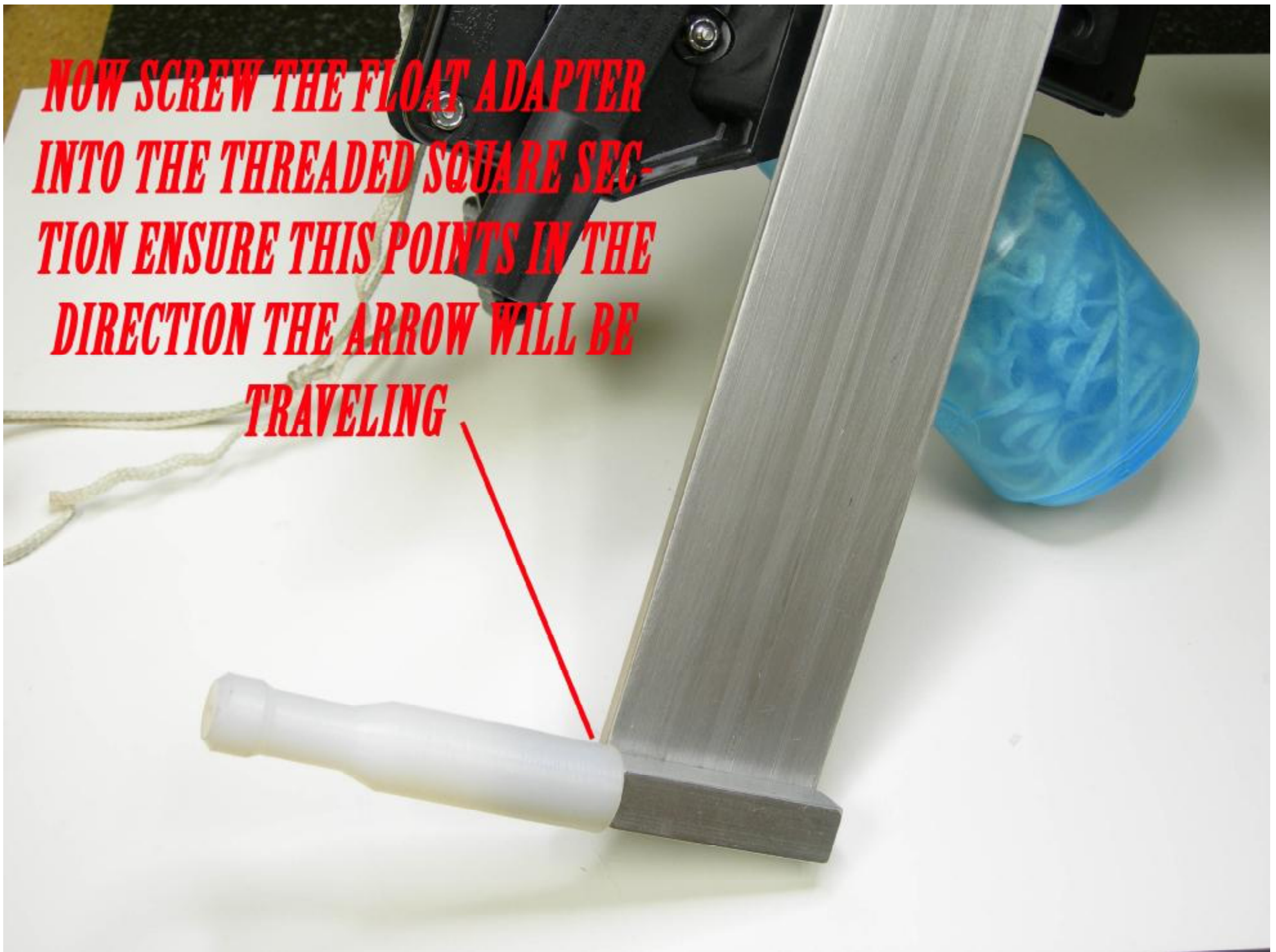



***THEN SLIP THE FLOAT OVER
THE FLOAT ADAPTER WITH
THE STRING ATTACHED***

LAY THE LINE DOWN IN THE TRACK OF THE BOW AND OVER THE FOOT STIRRUP GOING TO THE REEL AND SETTING THE ARROW OVER THE TRACK AND LINE ON THE CROSSBOW.

